



Approved by M.B.C.
dt. 19/09/2024.



THE SANCTION IS VALID
UP TO 16/12/2030

APPROVED
u. Paramanik
ASSISTANT ENGINEER (C)
BOROUGH No. XIII

1. ALL DIMENSIONS ARE IN MILLIMETRES.
2. THIS DRAWING SHOULD BE READ IN CONJUNCTION WITH ALL OTHER RELEVANT ARCHITECTURAL DRAWINGS.
3. ONLY WRITTEN DIMENSIONS SHALL BE FOLLOWED.
4. FOR DETAIL DESCRIPTION OF ITEMS REFER TECHNICAL SPECIFICATION.
5. ALL MKD. LEVELS/DIMENSIONS DENOTES STRUCTURAL LEVELS/DIMENSIONS WITHOUT FINISH.
6. FOR DIMENSIONS OF BEAM, COL. & OTHERS STRUCTURAL MEMBERS SHOULD BE FOLLOWED THE STRUCTURAL DWG.

Prasanta Kumar Ghosh
Prasanta Kumar Ghosh
Geotechnical Engineer
EMPANELLED NO. 6/1 (KMC)

SIGN. OF GEO - TECHNICAL ENGINEER

Utpal Saha
Utpal Saha
B. C. E., M. C. E. (STRUCT.)
F. I. E. - F1212601
KMC Empanelled Structural Reviewer
Class-1, E. S. R. - (I) 58/10

SIGN. OF STRUCTURAL REVIEWER

Ankit Agarwala
ANKIT AGARWALA
B.E. (CIVIL), M.E. (STR)
G. ENG., M.I. STRUCT. E. (LONDON)
Membership No. - 078392965
KMC EMPANELLED STRUCTURAL ENGINEER
CLASS-1, E.S.E. 1 / 172

SIGN. OF STRUCTURAL ENGINEER

MERLIN PROJECTS LTD.
Hansu Saha
Hansu Saha
Authorized Signatory

SIGN. OF OWNER

Subir Kumar Basu
SUBIR KUMAR BASU
Registered Architect
Regn. No. - CA/78/4375

SIGN. OF ARCHITECT

PROJECT TITLE:
PROPOSED ADDITIONAL FLOORS OVER AN ABOVE EXISTING RESIDENTIAL BUILDINGS G+20 STORIED (BLOCK - B, C & D) AND REPLACED B+G+4P+16 STORIED (BLOCK - F) BUILDING WITH MLC P U/S 394 OF KMC ACT 1980 AND TO BE READ WITH U/R 26 (2a) & (2b) FOR 3 NO. G+23 STORIED (HEIGHT - 75.150 M.) (BLOCK-B, C & D), 1 NO. G+20 STORIED (HEIGHT - 66.000 M.) (BLOCK-A), 1 NO. G+18 STORIED (HEIGHT - 59.900 M.) (BLOCK-E), 1 NO. G+3 STORIED (HEIGHT - 17.600 M.) (CLUB), & 1 NO. G+7P STORIED (HEIGHT - 24.00 M.) (BLOCK-F) AT PRE NO. - 260, MOTILAL GUPTA ROAD, KOLKATA - 700008 WARD NO - 122, BOROUGH NO - XIII, P.S. - BEHALA.
B.P NO - 2022130093, DATED - 07.07.2022.

THIS IS TO BE READ WITH U/R 69A1. (a) KMC BUILDING RULE 2009

ARCHITECT
Subir Kumar Basu
CONSULTING ARCHITECTS & ENGINEERS
4, BROAD STREET
CALCUTTA-700019

DRG. TITLE - DETAILS OF WATER RESERVOIR-1.

SHEET TITLE - PLAN & SECTION OF UGWR FOR FIRE FIGHTING & DOMESTIC.

DRAWING NO. - SKB/ML/UGWR/AR/31

DRAWN	A. BISWAS	DATE	02/07/2024	SHEET NO.	31
CHEK.	TAPAS SAHA			REV.	0
APPD.	S.K. BASU			SCALE	1:50
SHEET	A0				

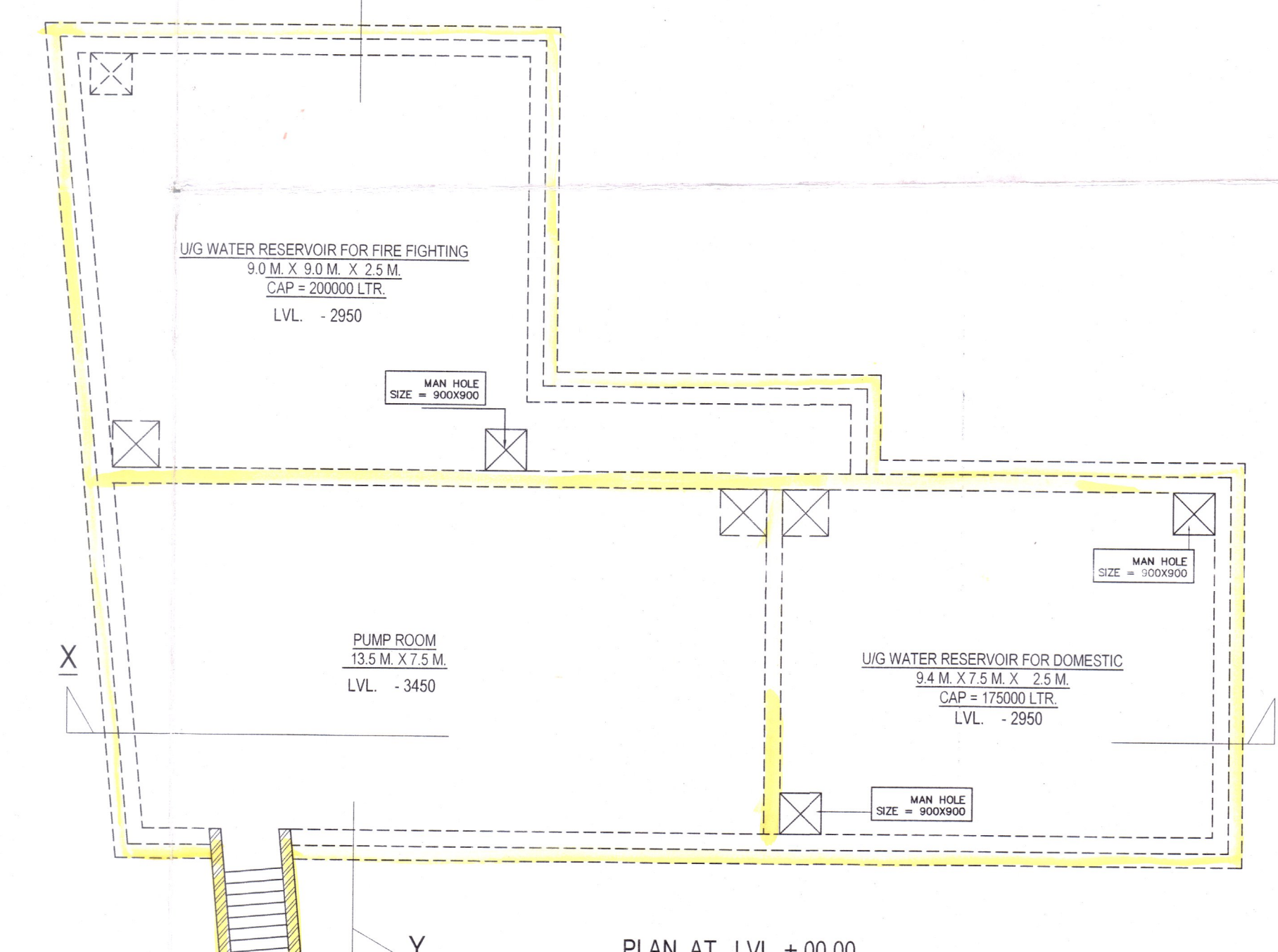
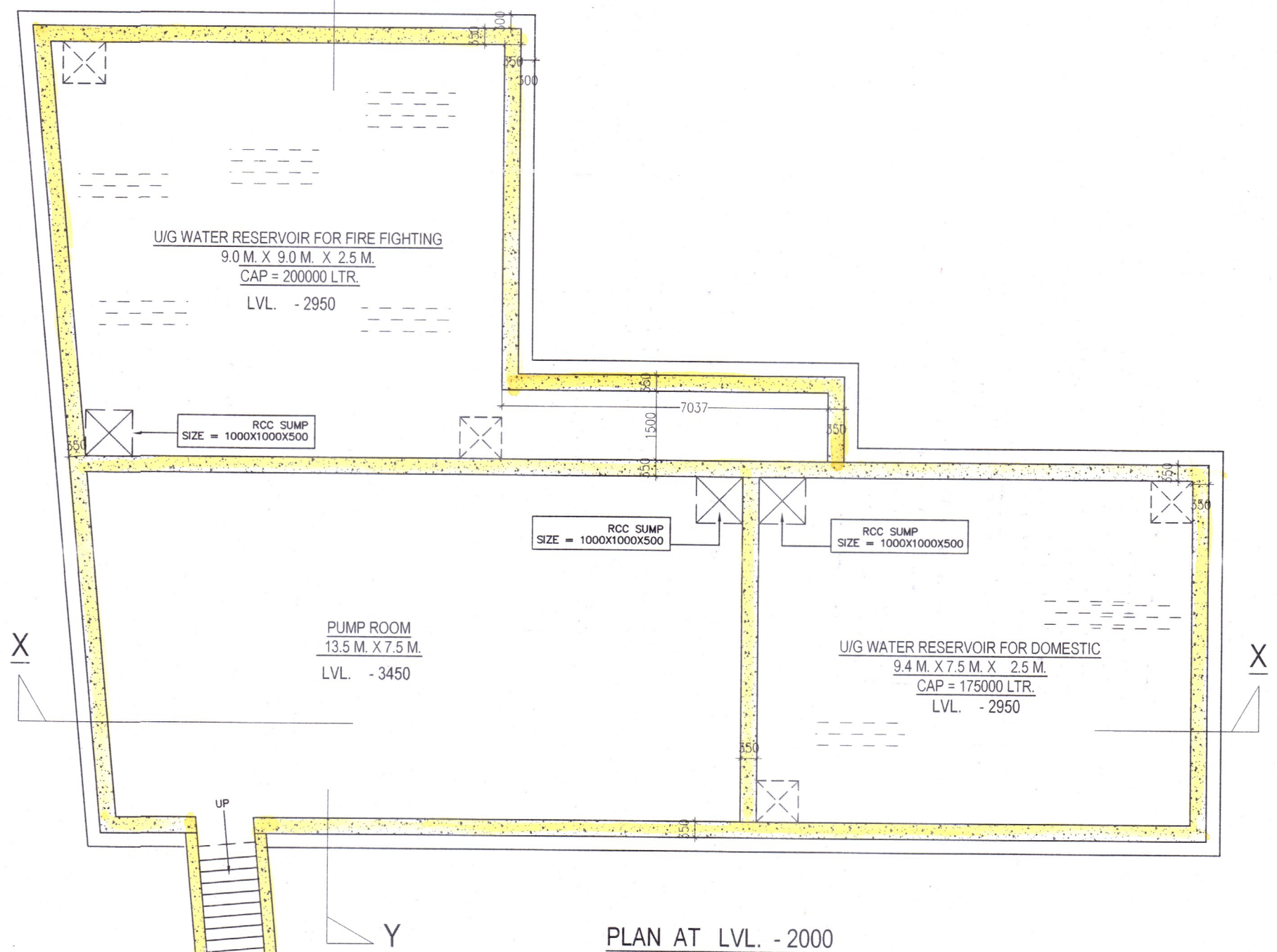
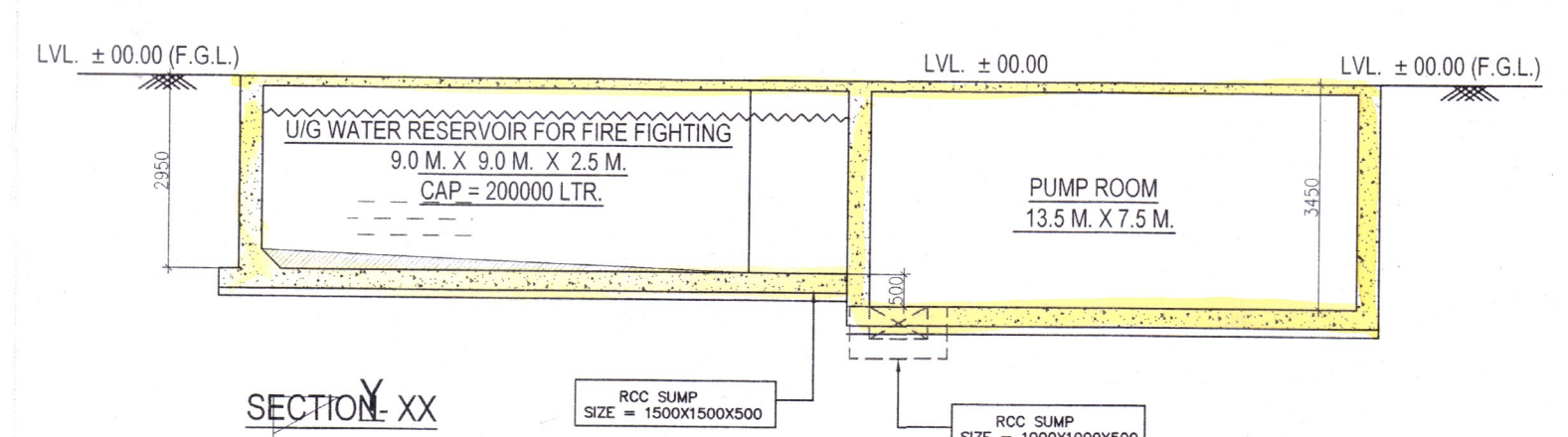
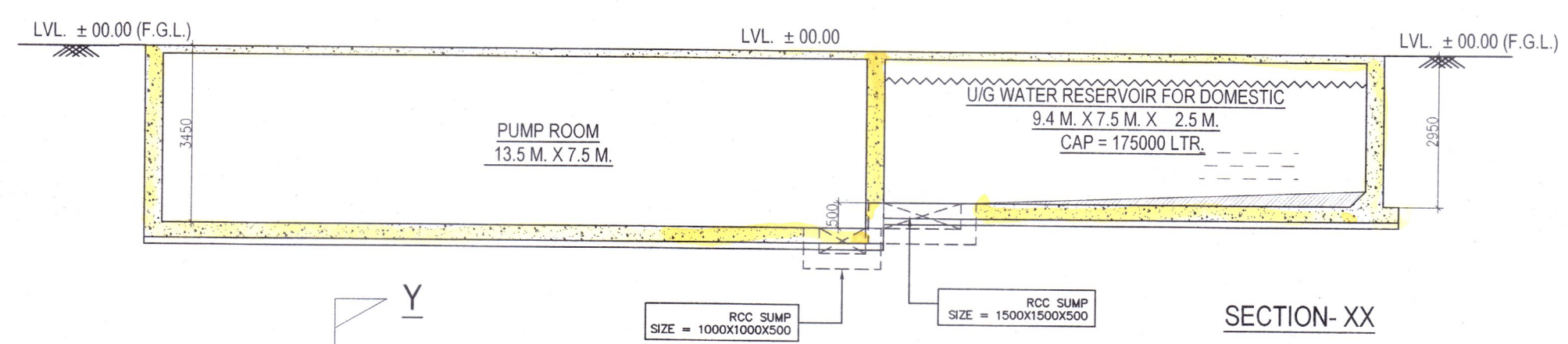

PLAN AT LVL. - 2000

PLAN AT LVL. ± 00.00

Plan Section of NGR
for Fire fighting &
Domestic

PARTY'S COPY

20/01/2024 (20) & (24) / 187-XIII / 24-25, dt-19/2/25

This Plan is To Be Treated As Part
And Parcel And Contiguous To
B.S. Plan No. 222/180/93
Dated 7.2.2009
Ex. Engineer (C-B)
Br. No.: XIII

Approved by M.B.C.
dt. 19/2/24

Vide Item No - 141 / 24-25.

RESIDENTIAL BUILDING

CONSTRUCTION SITE SHALL BE MAINTAINED TO PREVENT MOSQUITO BREEDING AS REQUIRED U/S 496(1) & (2) OF CMC ACT 1980, IN SUCH MANNER SO THAT ALL WATER COLLECTIONS PARTICULARLY LIFE WELLS, VATS, BASEMENT SURGING SITES OPEN RECEPTACLES ETC AS EMPITED COMPLETELY TWICE & WEAR

No rain water pipe should be fixed or discharged on Road or Footpath. Drainage plan should be submitted at the Borough Executive Engineer's Office and the plan should be obtained before proceeding with the drainage work

Before starting any Construction the site must conform with plans sanctioned and all the conditions as proposed in the plan should be fulfilled
The validity of the written permission to execute the work is subject to the above conditions

A suitable pump has to be provided i.e. pumping unfiltered water for the distribution to the flushing cisterns and urinals in the building incase unfiltered water from street main is not available

Plan for Water Supply arrangement including SEMILI G. & O. H. reservoirs should be submitted at the Office of the Ex-Engineer Water Supply and the sanction obtained before proceeding with the work of Water Supply any deviation may lead to disconnection/demolition.

DEVIATION WOULD MEAN DEMOLITION

CONSTRUCTION SITE SHALL BE MAINTAINED FREE FROM AIR POLLUTION ACCORDING TO UNDERTAKING SUBMITTED AS PER AMENDMENT DT. 31.01.2019 /IDE NO. 95/MA/OIC-4/ 3R-72017 OF SCHEDULE-IV OF KMC BUILDING RULE 2009

Non Commencement of Erection/ Re-Erection within Five year will Require Fresh Application for Sanction

All Building Materials to necessary & construction should conform's to standered specified in the National Building Code of India.

Design of all Structural Members including that of the foundation should conform to Standards specified in the National Building Code of India.

Necessary steps should be taken for the safety of the lives of the adjoining public and private properties during construction.

Fresh Plan.
P/C - 2024/130101.



CHECKED AND VERIFIED
A.E. (C)/S.A.E. (C)

KOLKATA MUNICIPAL CORPORATION
BUILDING DEPTT.
PLANS APPROVED U/R 28 (2a) & (2b) of
C.M.C. BUILDING RULES 2009
B.P. No. 2023/180/93 Dt. 7.2.2009
u. Parameswar
Assistant Engineer Ex Engr. (Civil)
Br. No.: XIII